

PLAN ARMARE PLACA COTA -0.05

1/50

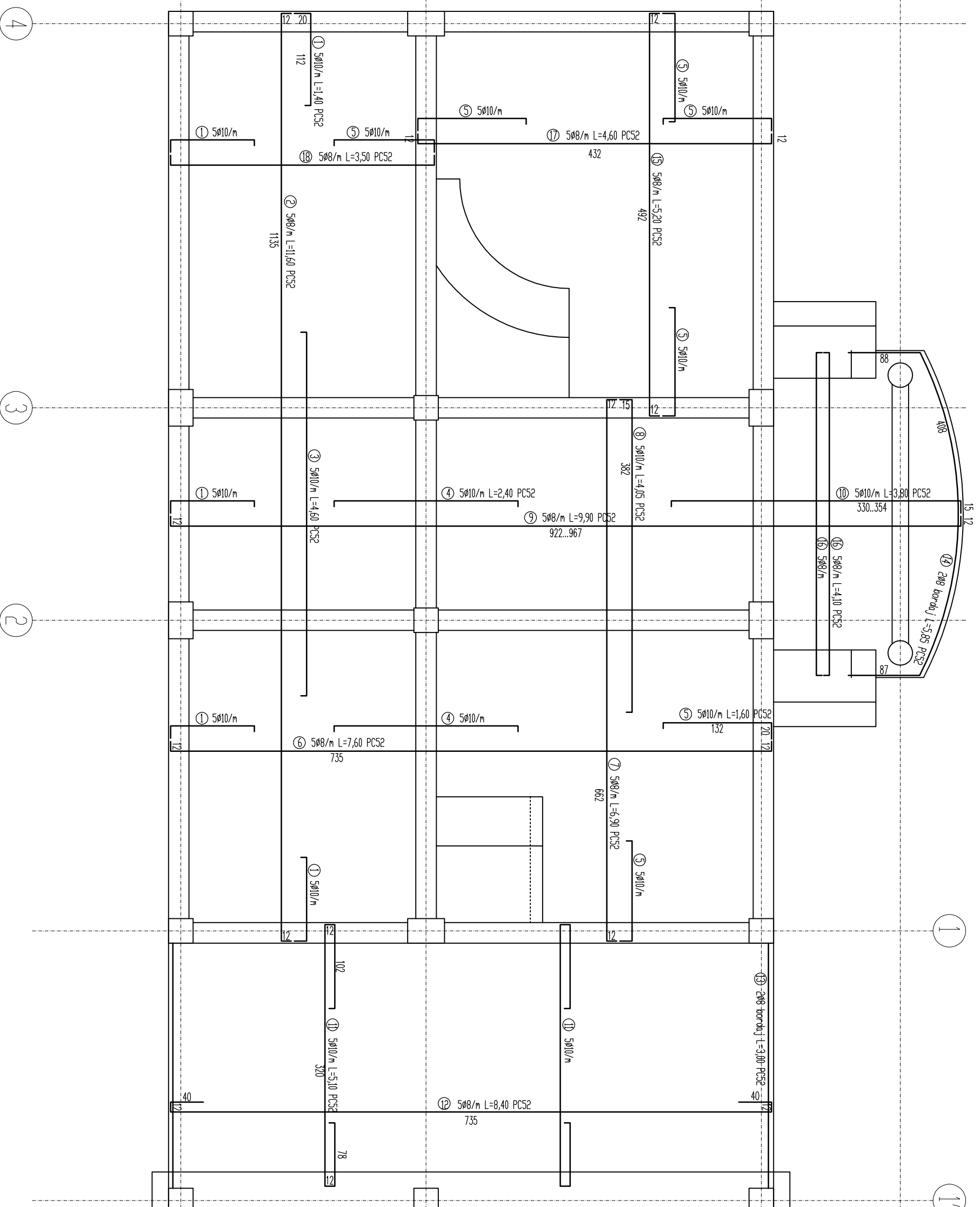

Marca	φ	L	Buc.	Consum armatura pt. Placa cota -0.05						
				Lungimi / φ						
				OB37 φ6	φ8	φ10	φ12	φ16		
1	10	1.40	81							
2	8	11.60	14			162				
3	10	4.60	14				64			
4	10	2.40	30				72			
5	10	1.60	147				235			
6	8	7.60	18			137				
7	8	6.90	20			138				
8	10	4.05	20				81			
9	8	9.90	21			208				
10	10	3.80	21				80			
11	10	5.10	35				179			
12	8	8.40	15			126				
13	8	3.00	2			6				
14	8	5.85	2			12				
15	8	5.20	23			120				
16	8	4.10	16			66				
17	8	4.60	23			106				
Total lungimi pe φ (m)						1080	824			
Greutate pe ml (kg/m)						0.22	0.39	0.62	0.89	1.58
Greutate pe φ (m)						426	508			
Greutate totala (kg)						934				

CLASIFICARE CF.P100/06: CLASA III DE
 IMPORTANTA, AMPLASAMENT: OTOPENI,
 jud. ILOV Ic=1,5 sec, og=0,24

BETON C20/25
 OTEL Pc 52,
 Acoperire cu beton c=15mm
 Cotele etrierilor se masoara la interior

Cota 0.00 este cota pardoselii finite de la parter